

New Interior Walls for Garage
JASON E. & WHITNEY S. NEWCOMB
7516 Gold Coast Lane
Hanover County, Virginia 23111

REVISIONS:	
#	DATE

DATE: 2/8/19

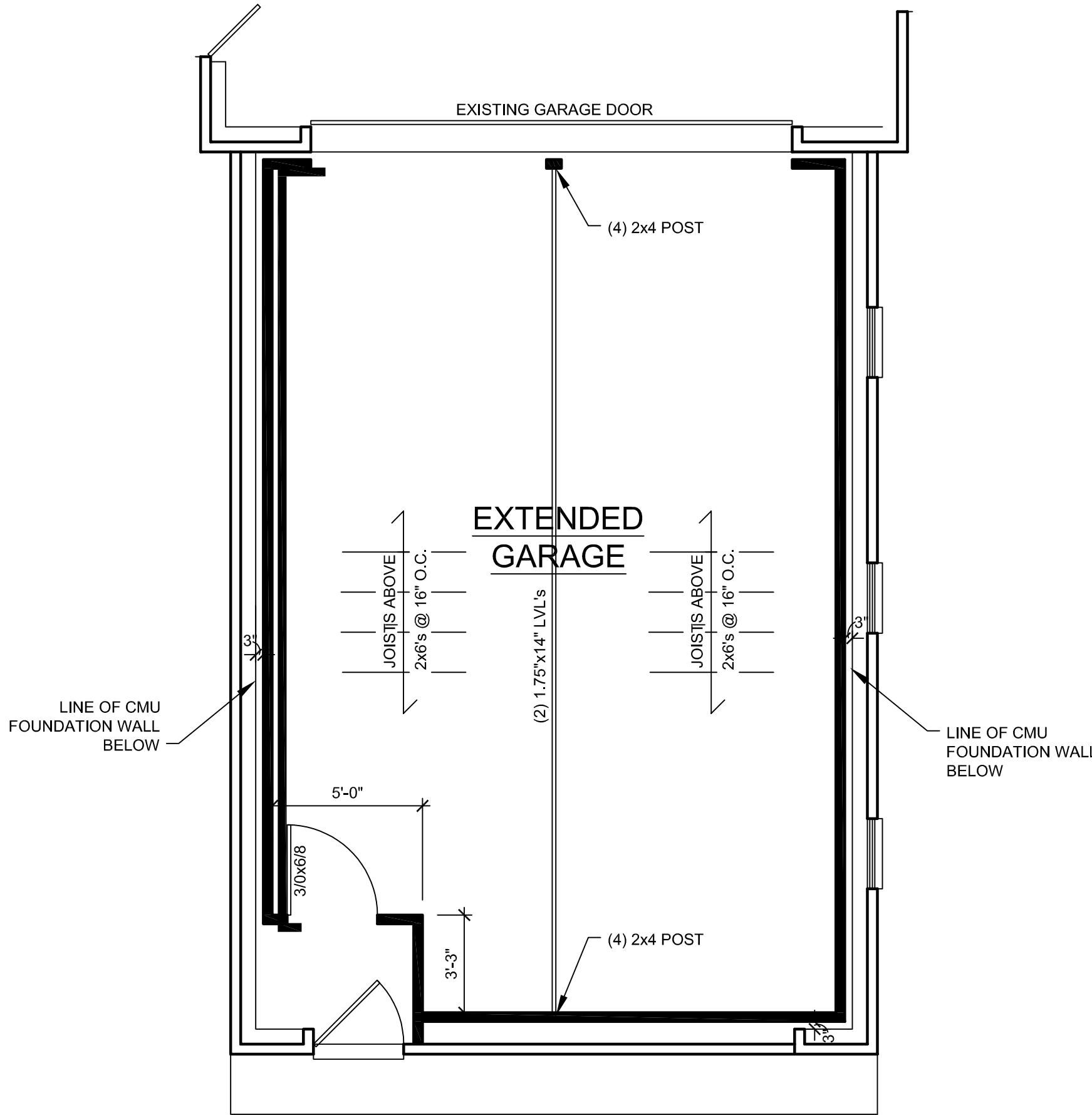

FIRST FLOOR PLAN

0' 2' 4' 8' 1/4" = 1'-0"

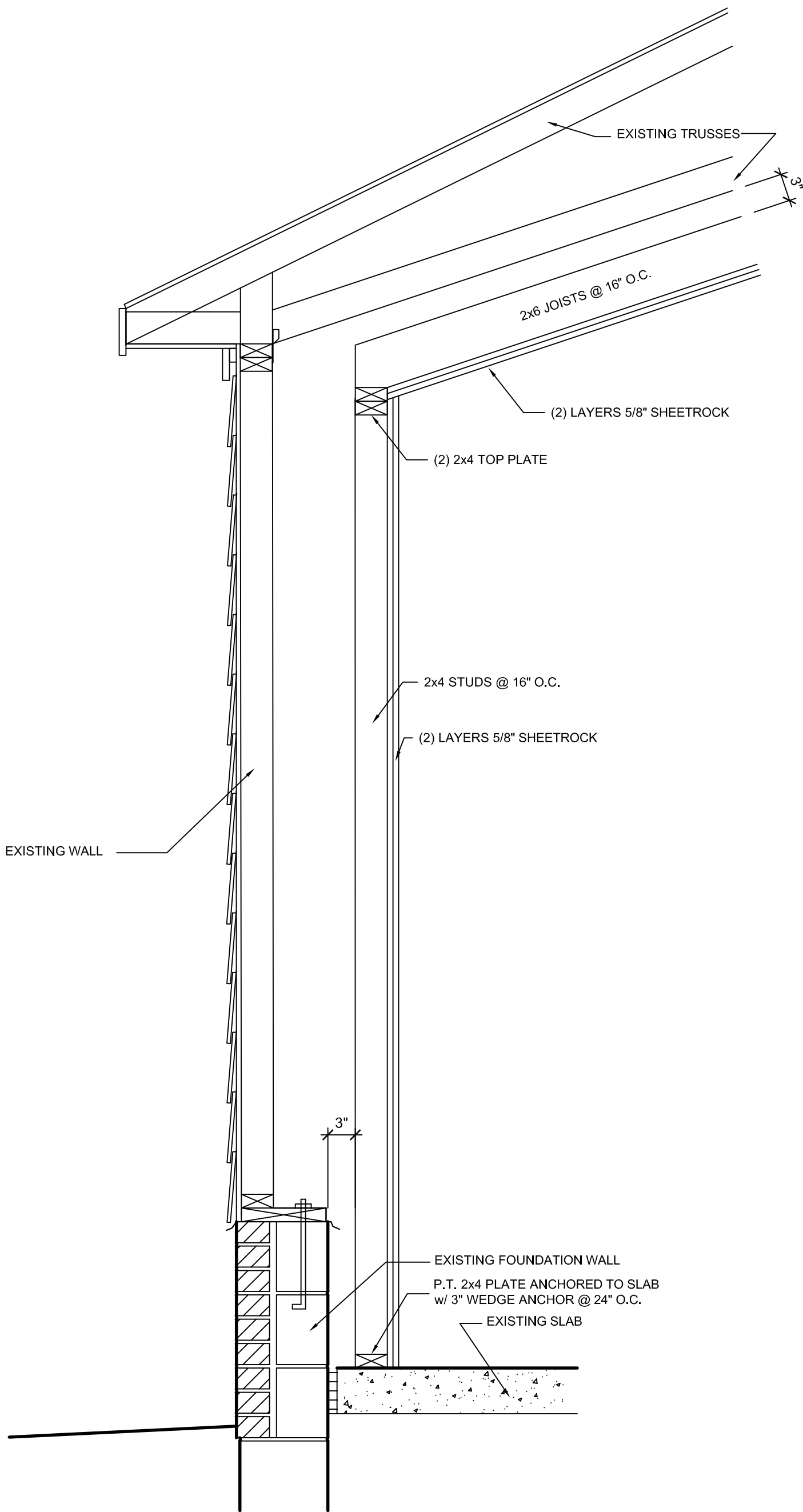

TYPICAL WALL SECTION

0' 6" 1' 2' 1" = 1'-0"